

# SENSORY MAP

This map of the Singapore History Gallery indicates areas where there may be excessive light or sound, or sudden changes. It also shows areas within the gallery that are relatively quiet. A suggested wheelchair-friendly route is also included in this map for visitors to move around the gallery with relative ease. We recognise that not all sensitivities and needs are accounted for in this map. Please speak with any Visitor Services staff if you or a loved one needs additional assistance.

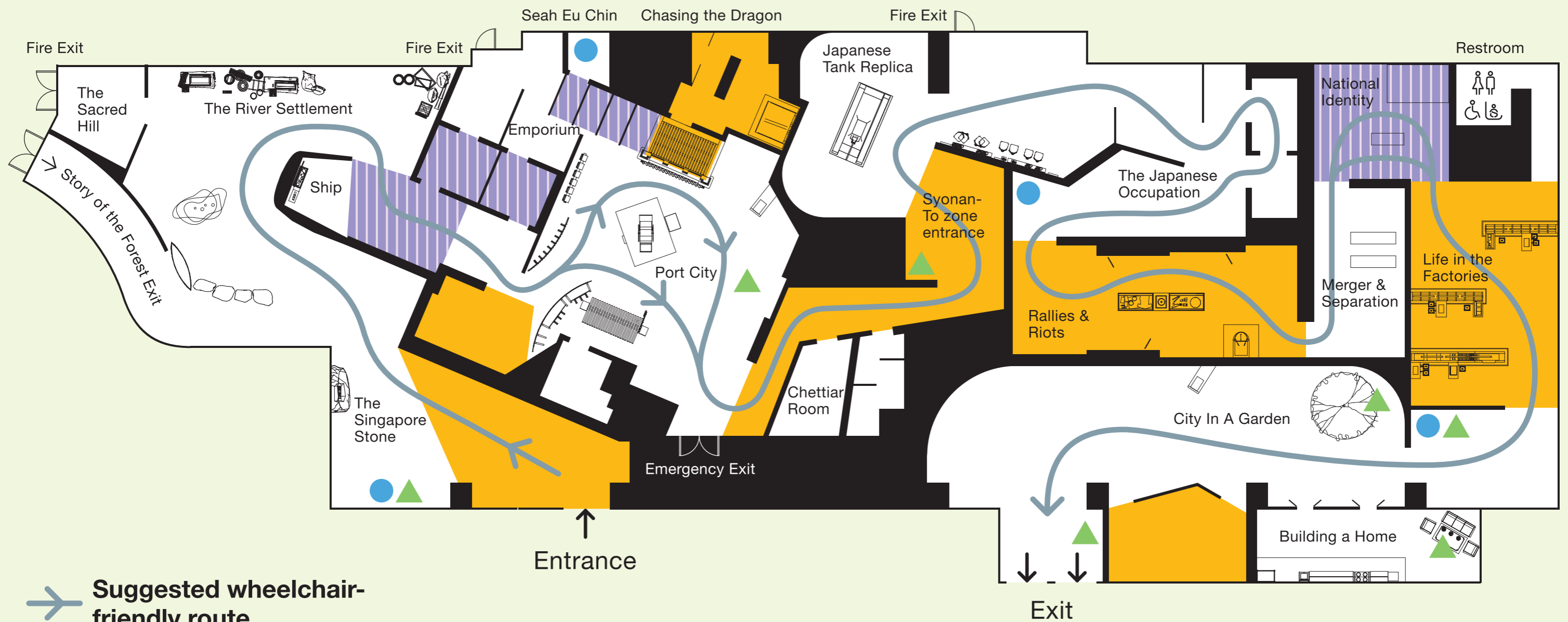

→ Suggested wheelchair-friendly route

● Quiet Corners  
Calming areas that may be suitable for persons with special needs

▲ Seating Areas  
For visitors who need to rest

▮ Surprise Areas  
Areas with changes in light and/ or sound

▨ Dim Areas